

*Cilindro a corsa breve alesaggio 20 corsa 5- a doppio effetto Stelo passante
Magnetico*

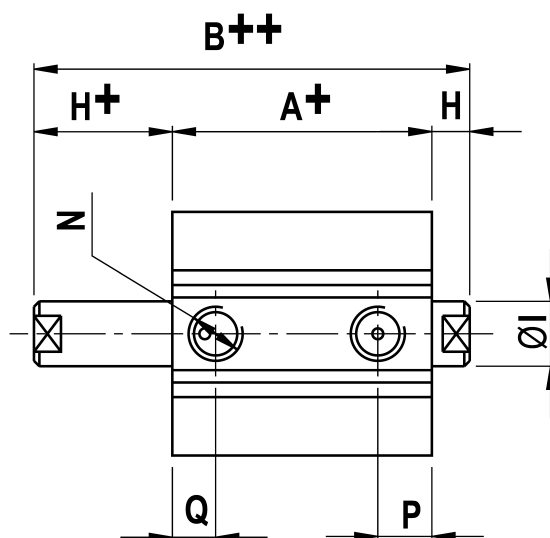

CARATTERISTICA	VALORE
Alesaggio (mm)	20
Corsa (mm)	5
Pressione di esercizio	[2;10] bar
Temperatura ambiente di lavoro	[-10;+85] °C

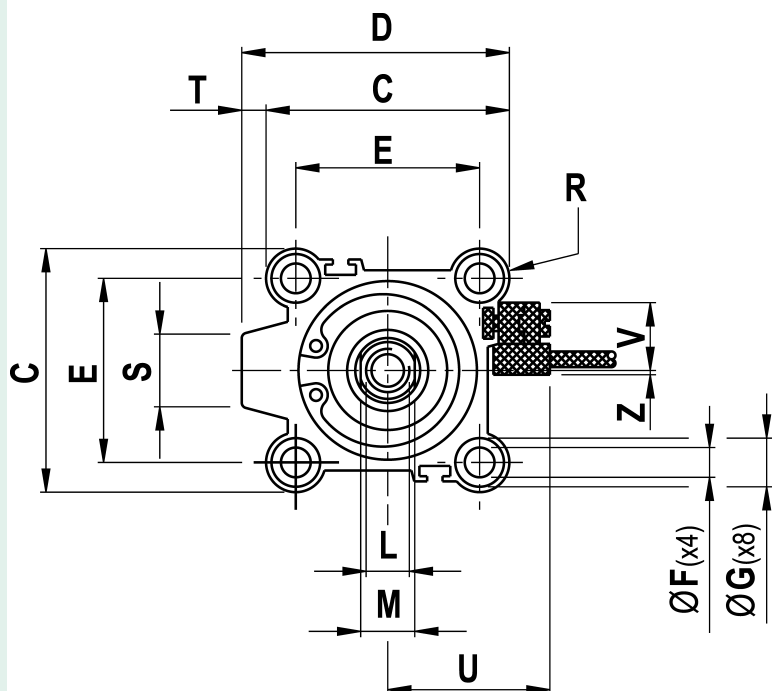
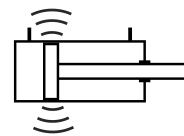

+ = corsa - stroke **++** = corsa (2x) - stroke (2x)

Originale: 11069×5331 px (937.2×451.4 mm) | Mostrata: 189.0×91.0 mm | Ridimensionata: Sì

A	B	C	D	E	F	G	H	I	L	M	N	P	Q	R	S	T	U	V	Z
38,0+	47,0++	36	36	25,5	5,5	8,7(x5,5)	4,5	10	M5(x5,5)	8	M5	9	9	5,25	11	-	26	8	6